

# PRINTABLE INFO SHEET



Series: Summit

Model: RAE102A Edenton



## About This Model

Style: Ranch / Bedrooms: 3 / Bathrooms: 2 / Square Feet: 1788

## CUSTOMER CONTACT

Notes:

---

---

---

---

# PRINTABLE INFO SHEET



Series: Summit  
 Model: RAE102A Edenton

## Floorplan

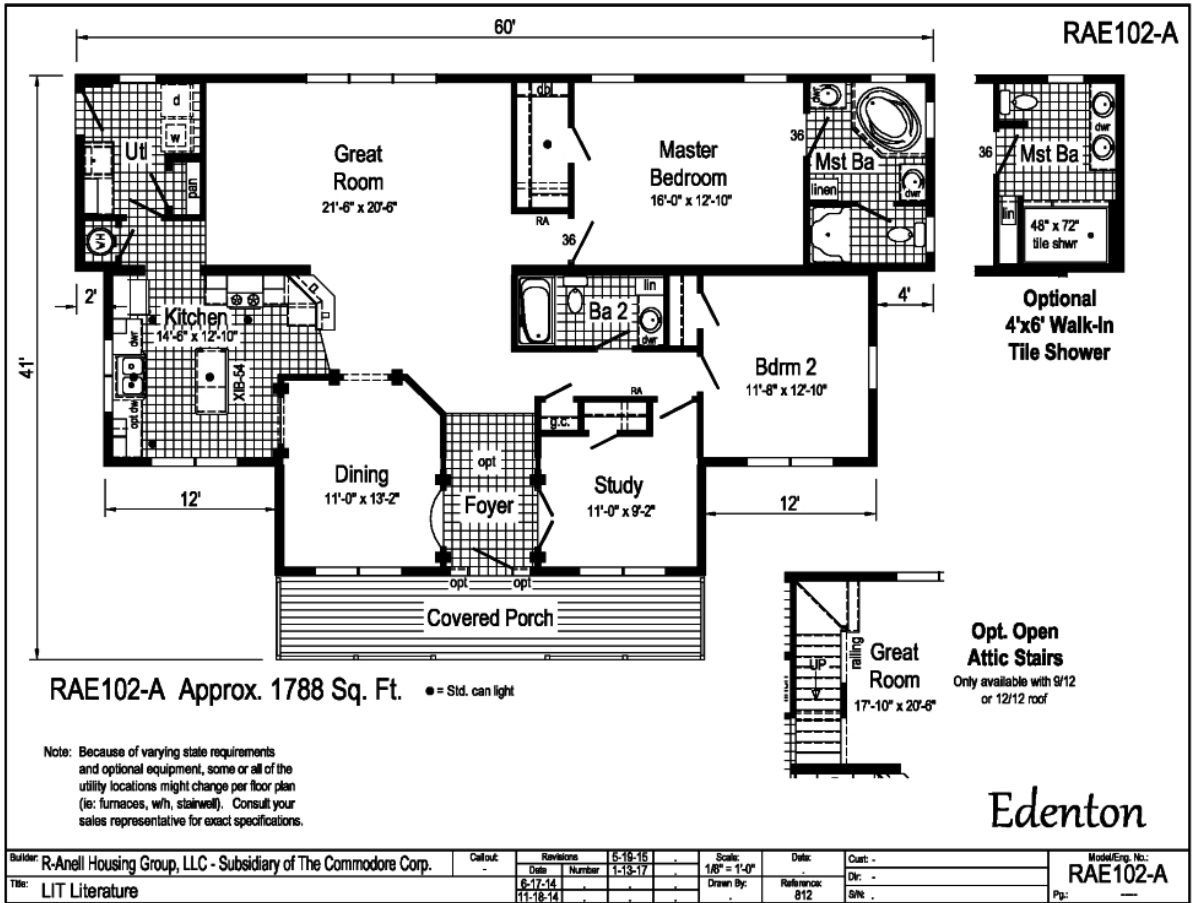

## CUSTOMER CONTACT

Notes:

---



---



---



---

# PRINTABLE INFO SHEET



**Series: Summit**

**Model: RAE102A Edenton**

## Standards & Features

### INTERIOR

- Primed Smooth Drywall Throughout
- Flat Ceiling Throughout
- Smooth Finish Coveless Ceiling
- 9'-0" Ceiling Height
- 25 oz. Carpet with ShawGuard Carpet Protector
- Rebond Carpet Pad
- Wet Areas Nafco 16x16 Floor Tiles or Volare Plank Flooring
- Langford 5-Arm Dining Room Light
- Langford 3-Arm Alabaster Glass Nook Light
- Pre-Hung Doors w/ Mortise Hinges
- Craftsman White 5-Panel Interior Doors
- Metal Interior Passage Sets
- Floor Mount Door Stops
- Smoke Detectors with Battery Back-Up
- Wire Shelving in Guest Closet & Utility Room
- Craftsman White Painted Mouldings
- Square Stairwell Railing & Posts
- Laminate Countertops with Crescent Edging
- Laminate Backsplash

### KITCHEN

- Recessed 6" LED Lighting
- USB Receptacle
- 30" Deluxe Free-Standing Electric Range
- Power Range Hood with Light
- 18 Cubic Foot, No-Frost Refrigerator
- Drop-In Offset Double Bowl Sink
- Brushed Nickel Coil Spring Goose Neck

### KITCHEN (continued)

Faucet

### CABINETRY

- Evermore Custom Cabinetry (KCMA Certified)
  - Hardwood Mission Cabinet Doors with Full Overlay
  - Hardwood Cabinet Face Frames
  - Brushed Nickel Cabinet Hardware
  - Concealed Cabinet Hinges
  - Undermount Roller Guide Drawer System
  - Dovetail Drawers
  - Kitchen Island w/ 3" Stile Framed Panels on Sides & Back
  - Lined Overhead Cabinets
  - Crown Moulding on Overhead Cabinets
  - Hardwood Undercabinet Moulding in Kitchen
  - 42" Overhead Cabinets
  - Adjustable Shelves in Overhead Cabinets
  - Bumped Out Kitchen Sink Cabinet
  - Base Shelf in Vanities
  - 36" High Bath Vanities
- ### BATHS
- 60" One-Piece Fiberglass Tub/showers with Ceramic Tile Edge
  - One-Piece Fiberglass Shower with Ceramic Tile Edge and a Glass Door in Glamour Baths
  - Fiberglass Soaker Tub in Glamour Baths
  - Tub Overflows
  - 1.6 Gallon Per Flush Elongated Toilets

## CUSTOMER CONTACT

Notes: \_\_\_\_\_  
\_\_\_\_\_  
\_\_\_\_\_  
\_\_\_\_\_

# PRINTABLE INFO SHEET



**Series: Summit**

**Model: RAE102A Edenton**

## Standards & Features (continued)

### CABINETRY (continued)

- China Stool, Tank and Lid
- China Sinks with Overflows and Pop-Up Drains
- 2-Arm Vanity Light
- Lighted Vent Fan in Each Bath
- Huntington Brass Sherington Faucets
- Anti-Scald Valves on Showers

### BEDROOMS

- Ceiling Lights
- Egress Window in Each Bedroom
- Wire Shelving in Secondary Closets
- Switched 4" LED Light in All Walk-In Closets

### EXTERIOR

- Prairie Charcoal Lantern Light at Front Door
- Patina Lantern Light at Rear Door
- Two GFI-Protected Exterior Receptacles
- Vinyl Dutch Lap Siding
- Shutters on Front Door Side
- O.S.B. Sheathing
- 7/12 Roof Pitch
- 12" Overhangs & Eaves
- 10" Overhangs & Eaves - RAB Models
- Ridgevent Roof Ventilation System
- 3/0 x 6/8 Fiberglass 1/2 Lite Prairie Grid Front Door w/ Dead Bolt
- 3/0 x 6/8 Fiberglass 6-Panel Rear Door w/ Dead Bolt
- Plygem 62" Single Hung Low-E Windows w/ Prairie Grids
- Wind Wrap

### EXTERIOR (continued)

- Vapor Barrier
- Archititctural Shingles
- UTILITIES
- 200 AMP Electrical Service
- Arc Fault Circuit Breakers
- 5-Wire A/C Thermostat
- Plumb and Wire for Washer
- Wire and Vent for Dryer
- Perimeter Boots & Registers
- Box Air Return System Through Floor
- 50 Gallon Electric Water Heater with Pan
- Copper Wiring Throughout
- Main Water Line Shut-Off Valve
- Water Shut-Off Valves Where Accessible
- Drain Lines Stubbed Though Floor
- One Exterior Water Faucet
- Recessed Dryer Vent Box - Where Available

### CONSTRUCTION

- 2x10 Transverse Floor System on 16"Centers with 3/4" T&G O.S.B. Floor Decking\*\*
- Toilet Riser in Wall
- 2x6 Exterior Walls
- 2x4 Interior Walls
- 2x4 Marriage Walls
- Uponer Plumbing Connections
- 88" Window Headers
- 90 MPH Exposure B Wind Load
- 20# Roof Load Design

## CUSTOMER CONTACT

Notes:

---

---

---

---

## PRINTABLE INFO SHEET

**Series: Summit**

**Model: RAE102A Edenton**



## Standards & Features (continued)

### **INSULATON**

R-19 Fiberglass Insulation in Walls

R-31 Avg. Blown Insulation in Ceiling

### **Virginia Built Homes**

R-19 Fiberglass Insulation in Wall

R-38 Avg. Blown Insulation in Ceiling

Foam Gaskets at Switches & Recept on exterior Walls

Insulated Hot Water Lines

\*\*Spacing for Framing Members may vary due to Design

Requirements

## CUSTOMER CONTACT

Notes:

---

---

---

---